

# LOT 2

355sqm  
SANDY

NOTE: BOUNDARY POSITION APPROXIMATE ONLY REQUIRES REPEG SURVEY  
NOTE: APPROXIMATELY 2.4 Km FROM COAST LINE

NOTE: ADD 44.88 TO ALL LEVELS ON PLAN TO OBTAIN APPROXIMATE A.H.D. LEVELS. THIS VALUE DERIVED FROM WATER CORP. AS CONSTRUCTED RECORDS & MAY NOT BE EXACT. AN A.H.D. SURVEY IS REQUIRED TO OBTAIN AN ACCURATE VALUE.

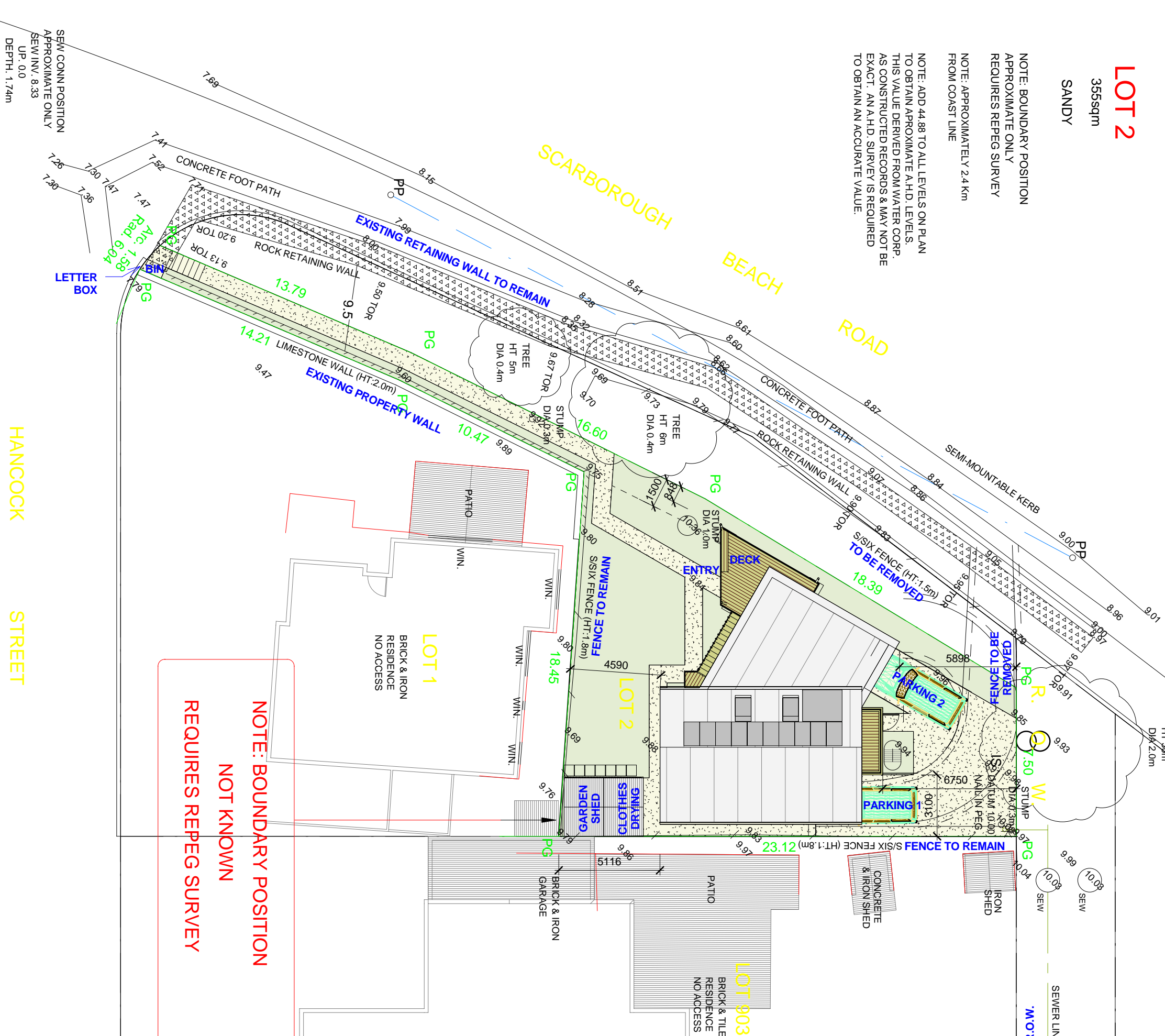

**NOTE: BOUNDARY POSITION NOT KNOWN REQUIRES REPEG SURVEY**

<b>CLIENT</b>	WETJEN	<b>BUILDER</b>	WETJEN, CHRISTIAN
<b>LOT</b>	2 HANCOCK STREET	<b>AUTHORITY</b>	STIRLING
<b>SUBURB</b>	DOUBLEVIEW	<b>MAP REF.</b>	311 16 62
<b>PLAN</b>	S 39805	<b>C/T Vol.Fol.</b>	2503/745
<b>DATE OF SURVEY</b>	19.12.08	<b>SCALE</b>	1:200
<b>JOB No. OURS:</b>	154004	<b>YOURS:</b>	WETJEN

<b>SCALE BAR</b>		<b>DRAFTED M.R.</b>	
<b>GAS SERVICE INFORMATION</b>	BTC	<b>SEWERAGE</b>	YES
<b>AREA ESTABLISHED</b>	TELSTRA	<b>POWER</b>	O/H
<b>WATER</b>	SV STOP VALVE	<b>HYDRANT</b>	FP FLUSH POINT
<b>SEWERAGE</b>	SW SEWER MANHOLE	<b>INSPECTION SHAFT</b>	INSPECTION OPENING
<b>POWER</b>	CP CONSUMER POLE	<b>POWER POLE</b>	LAMP POST
<b>STORMWATER</b>	SW MANHOLE	<b>GRATE</b>	SIDE ENTRY PIT
<b>SURVEY</b>	PF PEG FOUND	PDIST PEG DISTURBED	PG PEG GONE
		STATION	*

**AUTOMATED SURVEYS**  
LICENSED SURVEYORS AND DEVELOPMENT CONSULTANTS

PTY LTD  
3 Old Street West Perth WA A 6105  
Telephone: +61 (08) 9214 1777  
Facsimile: +61 (08) 9214 1778

P.O. Box 198 West Perth WA A 6872  
This information is current as at the date of survey. Services are to be confirmed with relevant Authorities. This includes without limitation: Suez, Water Supply, Drainage, Power Supply, Gas Supply & Communications. Further notices / indications / encumbrances may be listed on the Certificate of the Location of boundary in relation to fences or boundary markers is not guaranteed. Boundary is placed vertically as per 'as is'. Repeg Survey will be required. Copyright © 2008 Automated Surveys Pty. Ltd. All rights reserved.

**234A HANCOCK STREET DOUBLEVIEW**

**SITE PLAN WITH SURVEY A-108**

FEBRUARY 2009 SCALE 1 : 200

CHRISTIAN WETJEN  
3/26 SCARBOROUGH BEACH ROAD  
SCARBOROUGH, WA 6019  
0439461691  
CHRISTIAN.WETJEN@COX.COM.AU

# CD-W